

SCVHS 0611

VICINITY MAP

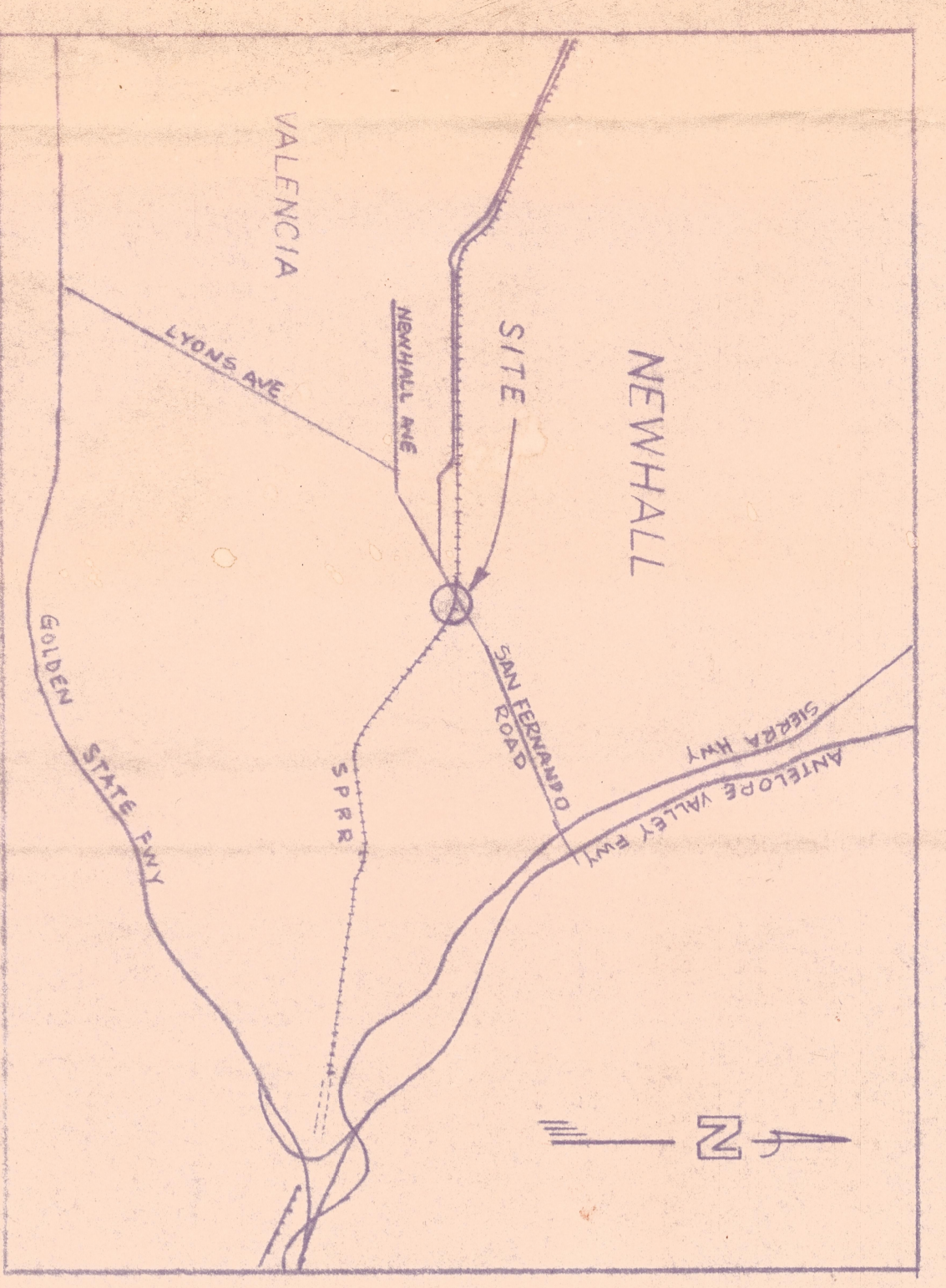

CONTOURS FROM LOS ANGELES COUNTY SURVEY DIVISION
JOB NUMBER 0755.34

- PLOT PLAN -

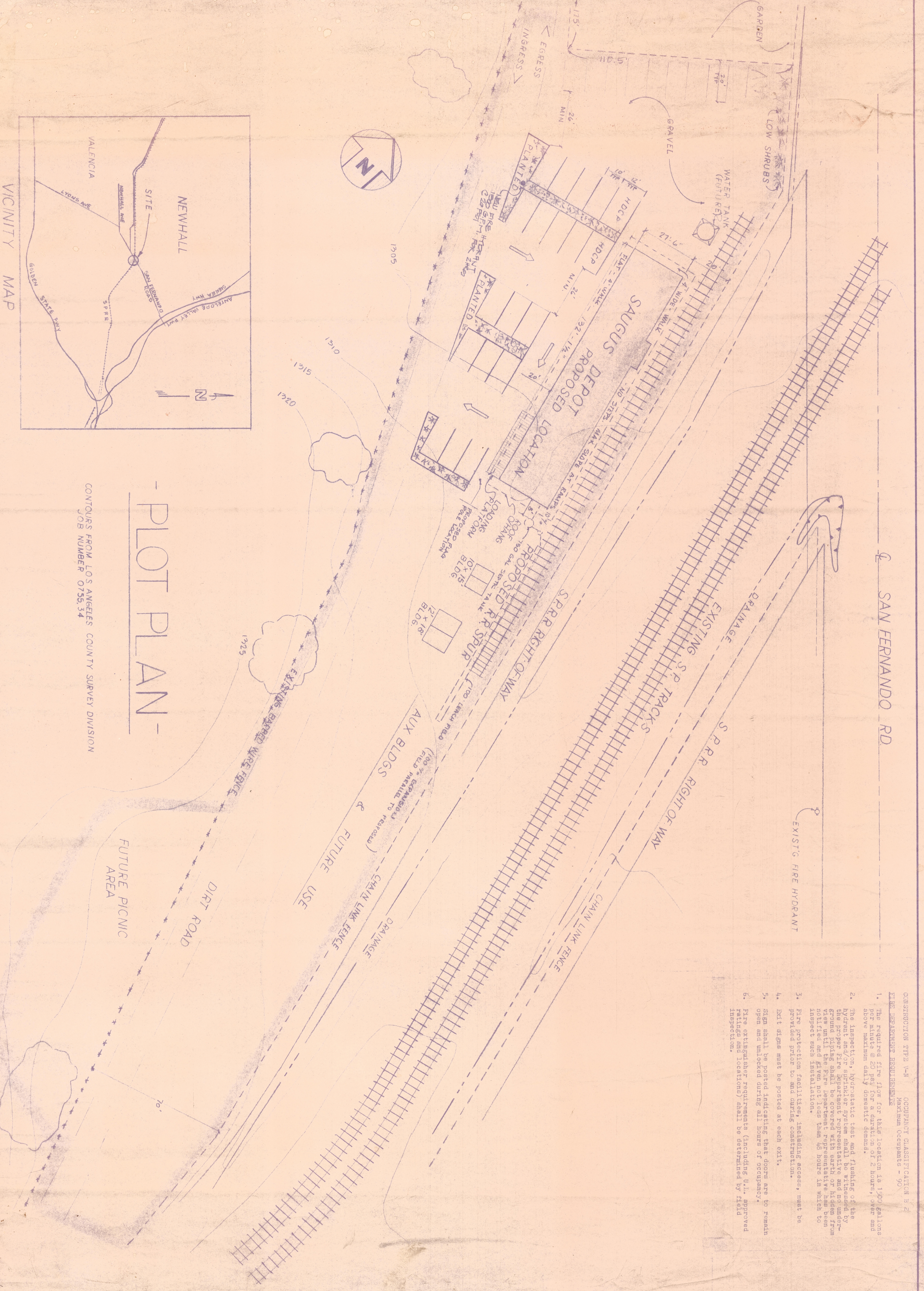

SAN FERNANDO RD

- CONSTRUCTION TYPE V-N OCCUPANCY CLASSIFICATION B-2
FIRE DEPARTMENT REQUIREMENTS Maximum Occupants - 90
- The required fire flow for this location is 1900 gallons per minute @ 20 psi for a duration of 2 hours, over and above maximum daily domestic demand.
 - The inspection, hydrostatic test and flushing of the hydrant and/or sprinkler system shall be witnessed by the proper fire department representative and no other personnel. The fire department representative has been notified and given not less than 48 hours in which to inspect such installation.
 - Fire protection facilities, including access, must be provided prior to and during construction.
 - Exit signs must be posted at each exit.
 - Signs shall be posted indicating that doors are to remain open and unlocked during all hours of occupancy.
 - Fire extinguisher requirements (including U.L. approved ratings and locations) shall be determined by field inspection.

HALE & ASSOCIATES INC. CONSULTING ENGINEERS 23922 AVENIDA CRESCENTA, VALENCIA, CA 805-269-9702	SANTA CLARITA VALLEY HISTORICAL SOCIETY SAUGUS DEPOT RELOCATION PROPOSED SITE DEVELOPMENT	<table border="1"> <tr> <th>REVISIONS</th> <th>BY</th> </tr> <tr> <td> </td> <td> </td> </tr> <tr> <td> </td> <td> </td> </tr> <tr> <td> </td> <td> </td> </tr> <tr> <td> </td> <td> </td> </tr> <tr> <td> </td> <td> </td> </tr> </table>	REVISIONS	BY										
REVISIONS	BY													

Date: 3/19/80
 Scale: 1/4" = 20'-0"
 Drawn: D.E.H.
 Job: E003016
 Sheet: 1 of 5